

CERTIFIED RECORD OF LAND CORNER MONUMENTATION

History of original corner establishment:

Corner established in 1882 by Eugene P. McCornack, Under General Land Office Contract No. 398. Surveyor Generals Notes State Set basalt stone 10x10x10" 7" in the ground for 1/4 section corner marked 1/4 on N face.

From Which:

A Pine 6" dia. bears N15°E, 15 lks dist. marked 1/4 S BT.
A Pine 8" " " S20°E, 32 " " " " " "

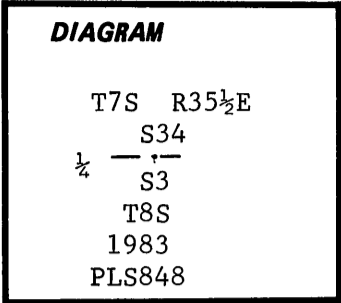

Description of corner evidence found:

Found a 10x9x9" stone firmly set in the ground with 1/4 on North face.

From which:

A dead and down Lodge-pole Pine scribed 1/4 S BT, bears N15°E, 11.0 ft.
A Rotten Lodge-pole Pine stump, no scribing visible, bears S20°E, 21.0 ft. Accepted position of stone as 1/4 corner.

Description of monument and accessories | established to perpetuate the original location of this corner:

Set a 30"x2 1/2" aluminum pipe with a 2 1/2" aluminum cap, stamped as shown in diagram. Set 22" in ground and set original stone North alongside pipe.

From which:

A Tamarack 10" dia. bears N76°E, 9.4 ft. scribed 1/4 S34 BT.
A Spruce 13" " " S47°W, 26.3 ft. " " S3 "

Set steel post with warning sign North 2.5 ft.

Nailed brass washers stamped PLS848, bearing tree and warning signs to each tree. Painted 6" red band around each tree.

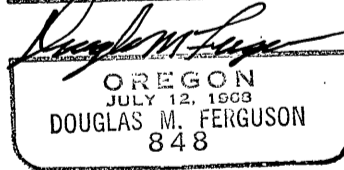
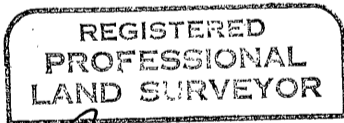

Corner monumented 8-31-83
Witnessed by Dan Martin

Office of... *Surveyor* ... County of... *Grant* ...
State of... *Oregon* ... I hereby certify that the within instrument was filed in this office
for record on the... *22* day of... *Nov* ... 19... *83*
Robert D. Bayett by
(COUNTY OFFICIAL) (DEPUTY)